



K系列快速排气阀
K Series Quick Exhaust Valve



订购码
Ordering code

K

气动元件
Pneumatic element

KP

表示快速排气阀
Indicating rapid venting valve

L

连接型式
接管式
Connecting type
Pipe fitting type

□

公称通径
Nominal diameter

符号
Symbol



规格
Specifications

参数 Parameter	订购码 Ordering code	KKP									
工作压力范围 Working pressure range		0.1~0.8									
介质温度 °C Fluid temperature		0~55									
环境温度 °C Ambient temperature		-10~55									
有效截面积 mm ² Net sectional area	P→A	10	20	40	60	110	190	300	400	650	
	A→O	20	40	60	110	190	300	400	650	900	
换向时间 S Reversing time		≤0.04		≤0.06		≤0.1		≤0.15		≤0.2	
泄漏量 cm ³ /min Leakage rate		≤10		≤25		≤50		≤70		≤70	
寿命 千次 / Thousands Life		≥1500									

尺寸
Dimensions

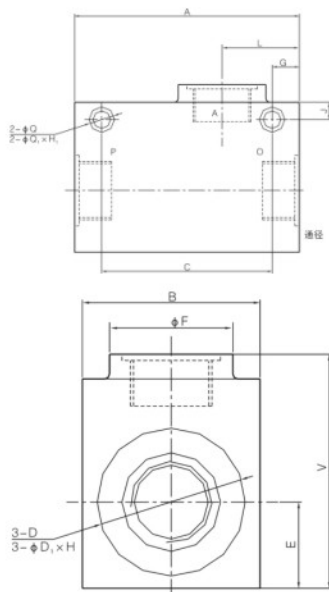

符号/型号 Symbol / Model	D	D1	Q	Q1	A	B	C	E	F	L	J	H	H1	G
KKP-L6	G1/8" M10 × 1	13	-	-	75	55	-	10	35	41	-	-	-	-
KKP-L8	G1/4" M12 × 1.25	16	-	-	75	55	-	10	35	41	-	1.8	-	-
KKP-L10	G3/8" M16 × 1	20	7	12	82	44	58	23	-	60	8	-	6	12
KKP-L15	G1/2" M20 × 1	24	-	-	82	44	58	23	-	60	8	-	6	12
KKP-L20	G1/2" M27 × 1	32	10	15	128	72	98	35	50	95	10	-	15	-
KKP-L25	G1" M33 × 1	40	-	-	128	72	98	35	50	95	10	2.7	-	-
KKP-L32	G1/4" M42 × 1	46	10	15	158	88	126	44	64	112	10	-	8	-
KKP-L40	G1/2" M48 × 1	54	-	-	158	88	126	44	64	112	10	-	8	-
KKP-L50	G2" M60 × 1	70	12	18	190	102	148	52	80	130	10	4.5	10	21

